

# VIDA

## RESIDENCES HILLSIDE

### TOWER A 2BEDROOM TYPE A

#### UNIT P02

|              |               |             |
|--------------|---------------|-------------|
| SUITE AREA   | 1105.56 SQ.FT | 102.71 SQ.M |
| BALCONY AREA | 229.81 SQ.FT  | 21.35 SQ.M  |
| TOTAL AREA   | 1335.37 SQ.FT | 124.06 SQ.M |

UNITS 104, 204, 304, 404, 504, 604, 704, 804, 904, 1004, 1104,  
1204, 1304, 1404, 1504, 1604, 1704, 1804, 1904, 2004

|              |               |             |
|--------------|---------------|-------------|
| SUITE AREA   | 1094.37 SQ.FT | 101.67 SQ.M |
| BALCONY AREA | 232.07 SQ.FT  | 21.56 SQ.M  |
| TOTAL AREA   | 1326.44 SQ.FT | 123.23 SQ.M |



#### KEY SECTION

#### KEYPLAN

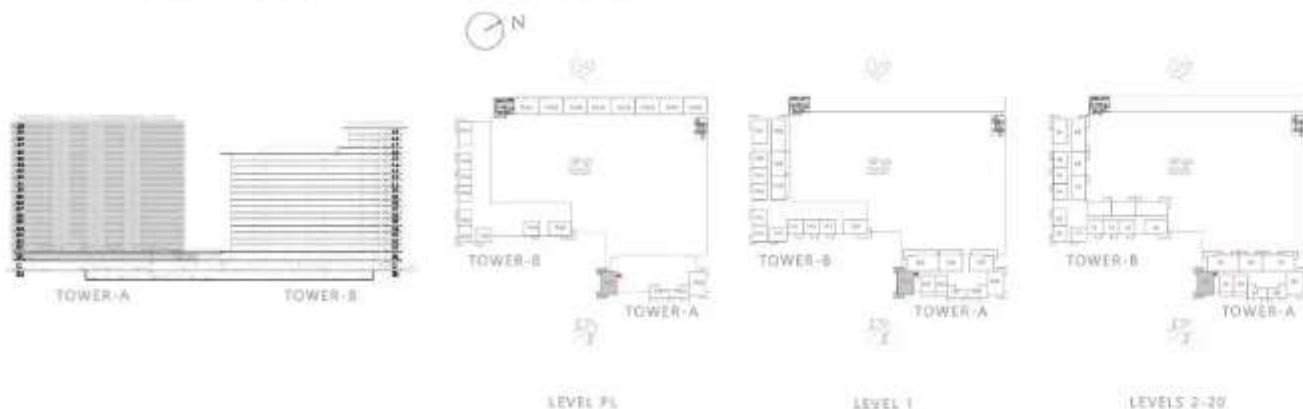

FLOOR PLAN 1. All dimensions are in Imperial and metric, and measured from finish to finish excluding construction tolerances. 2. All materials, dimensions, and drawings are approximate only. 3. Information is subject to change without notice, at developer's absolute discretion. 4. Actual area may vary from the stated area. 5. Drawings not to scale. 6. All images used are for illustrative purposes only and do not represent the actual size, features, specifications, fittings, and furnishings. 7. The developer reserves the right to make revisions / alterations, at its absolute discretion, without any liability whatsoever.